

# Access Junction C

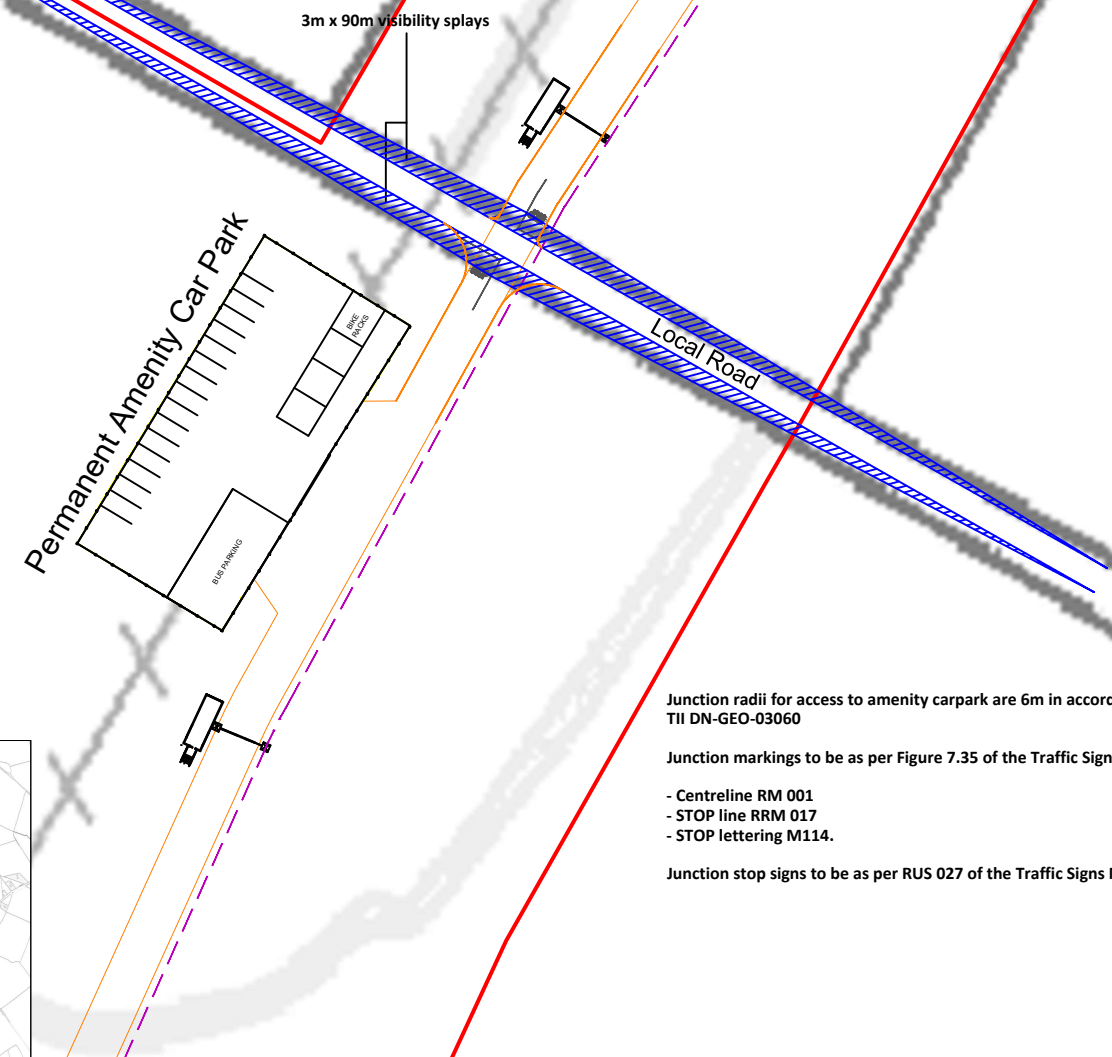

Junction radii for access to amenity carpark are 6m in accordance with TII DN-GEO-03060

Junction markings to be as per Figure 7.35 of the Traffic Signs Manual

- Centreline RM 001
- STOP line RRM 017
- STOP lettering M114.

Junction stop signs to be as per RUS 027 of the Traffic Signs Manual.

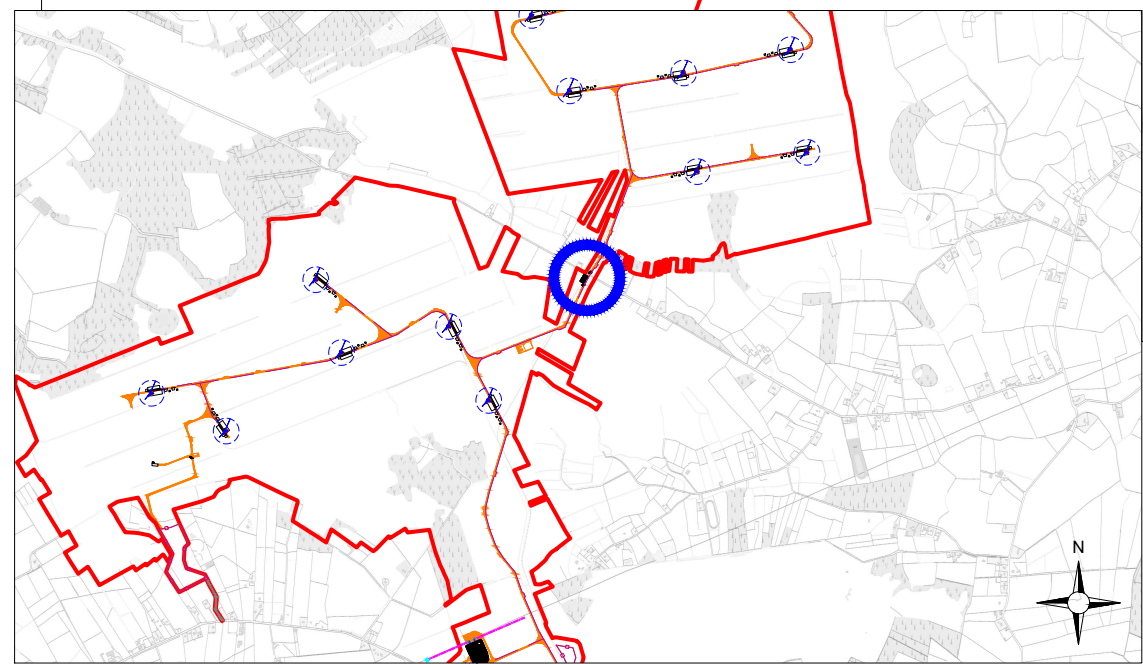
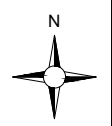

**Drawing Legend**

	Proposed Road
	Sight Line



DRAWING TITLE: <b>Proposed Access Junction C</b>	
PROJECT TITLE: <b>Ballivor Wind Farm, Co. Meath &amp; Co. Westmeath</b>	
DRAWING BY: <b>Joseph O'Brien</b>	CHECKED BY: <b>Karen Mulryan</b>
PROJECT No.: <b>191137</b>	DRAWING No.: <b>191137 - 100</b>
SCALE: <b>1:1,000 @ A3</b>	DATE: <b>27.03.2023</b>



**MKO**  
Planning and Environmental Consultants  
Tuam Road, Galway  
Ireland, H91 VW84  
+353 (0) 91 735611  
email: info@www.mkofireland.ie  
Website: www.mkofireland.ie